

MATERIAL NO.	ENGINEERING NO.	LENGTH
1300390311	DNB5000-M005	19.69 +1.75-0 [0.5M +44.5-0]
1300390312	DNB5000-M010	39.37 +2.19-0 [ 1.0M +55.6-0]

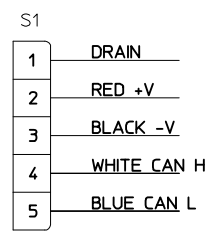
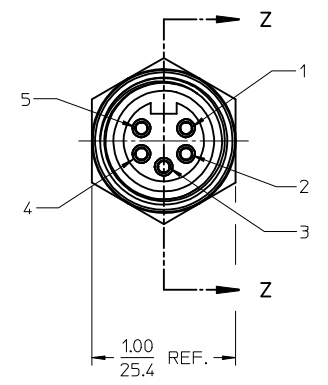
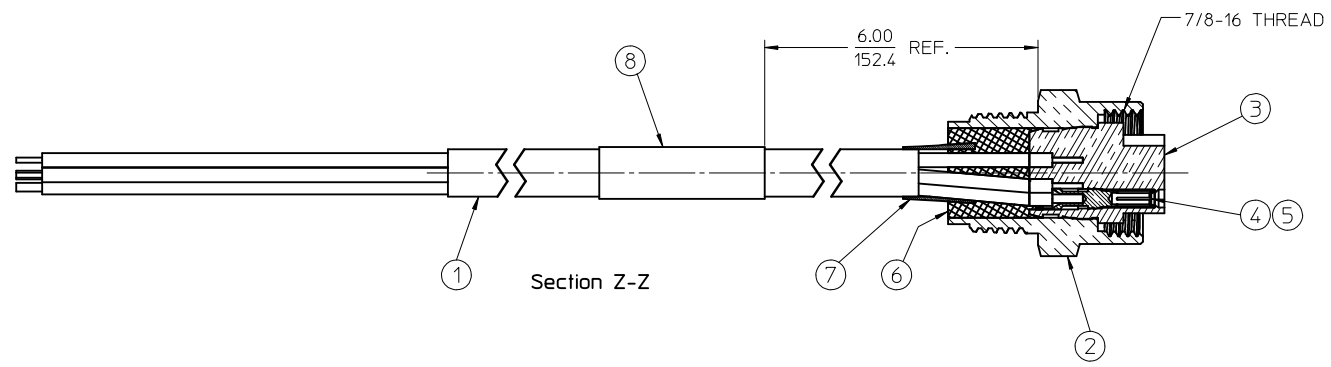
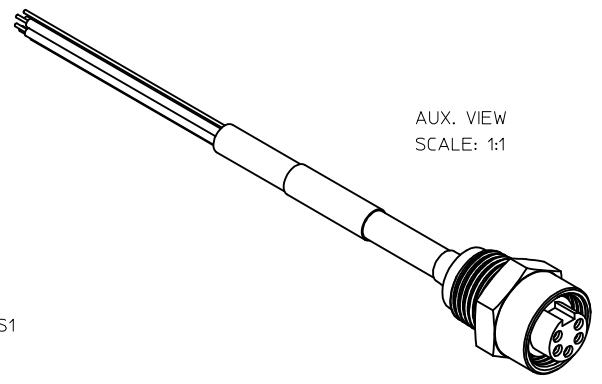
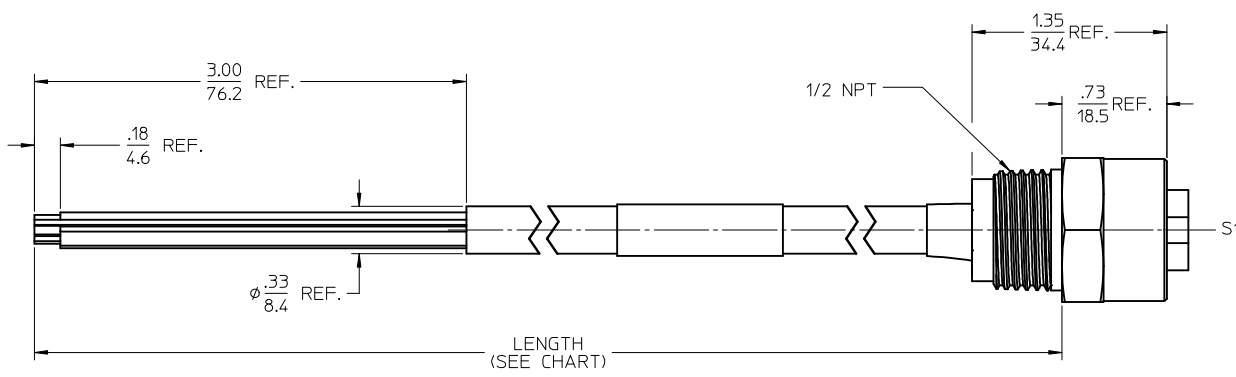

WIRING DIAGRAM

- NOTES:
1. MATERIAL: SEE TABLE
  2. FINISHES: SEE TABLE
  3. CABLE ASSEMBLIES ARE BAGGED SEPERATELY IN POLY BAGS WITH BARCODE LABEL ATTACHED TO OUTSIDE OF BAG
  4. WRAP LABEL IS MARKED WITH P/N, DATE CODE VOLTAGE & AMPERAGE
  5. MATES WITH: MINI CHANGE, A-SIZE 5 POLE CABLE ASSY.
  6. ELECTRICAL SPECIFICATIONS:  
VOLTAGE RATING: 300V  
CURRENT RATING: 4 AMPS
  7. ASSEMBLY IS RoHS COMPLIANT

ITEM	QTY.	DESCRIPTION	MATERIAL	FINISH
8	1	LABEL	PLASTIC FILM	BLACK/YELLOW
7	1	SHRINK TUBE	POLYOLEFIN	BLACK
6	1	POTTING	EPOXY	
5	5	SOCKET SLEEVE	ST.STEEL	
4	5	CONTACT SOCKET	BRASS	GOLD PLATED
3	1	INSERT	PVC	GRAY
2	1	RECEPTACLE SHELL	ALUMINUM	CLEAR ANODIZED
1	1	CABLE, DEV-NET, 16/20 AWG	PVC INSULATED	GRAY

RELEASED  
EC NO: WNA2009-0766  
DRAWN BY: R.STONE 2009/05/26  
CHKD BY: WOODMAN  
APPR: J.MURPHY 2009/06/10

QUALITY SYMBOLS  
▽=0  
▽=0

GENERAL TOLERANCES (UNLESS SPECIFIED)

	mm	INCH
4 PLACES ±	---	±---
3 PLACES ±	---	±---
2 PLACES ±	---	±.01
1 PLACE ±	0.3	±---

ANGULAR ±1/2°

DRAFT WHERE APPLICABLE MUST REMAIN WITHIN DIMENSIONS

DIMENSION STYLE IN/MM

SCALE 1.5:1

DESIGN UNITS INCH

THIRD ANGLE PROJECTION

DRAWN BY: R.STONE DATE: 2009/05/21

CHECKED BY: B.WOODMAN DATE: 2009/05/22

APPROVED BY: J.MURPHY DATE: 2009/05/27

MATERIAL NO. SEE CHART

SIZE C

MOLEX INCORPORATED

SD-130039-003

SHEET NO. 1 OF 1

THIS DRAWING CONTAINS INFORMATION THAT IS PROPRIETARY TO MOLEX INCORPORATED AND SHOULD NOT BE USED WITHOUT WRITTEN PERMISSION